

Vulcano Rectangular

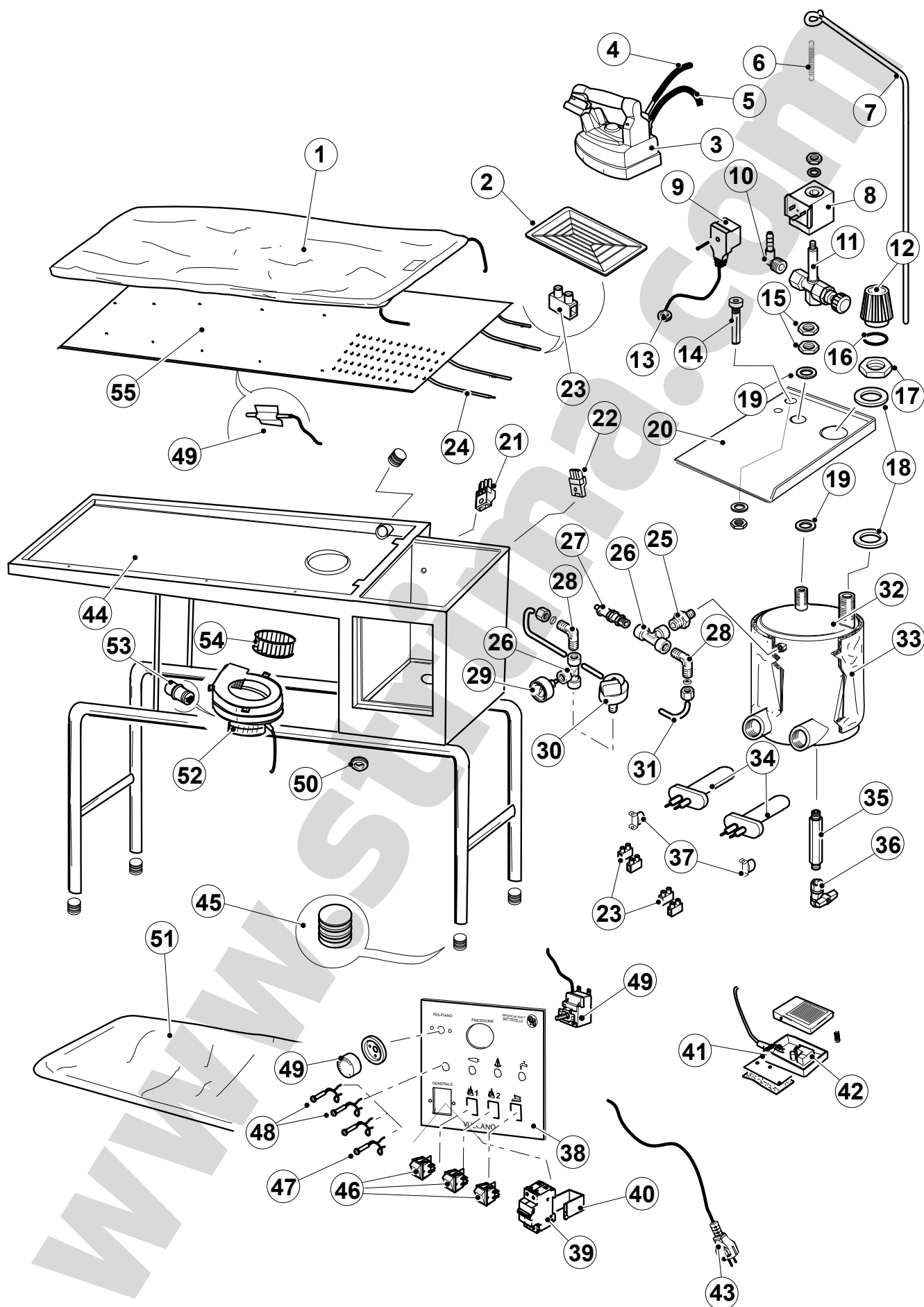

Vulcano Rectangular



POS.	Q.TY	CODE	DESCRIPTION
1	1	BATTISTELLA COVER VULCANO RECTANGULAR	Board prontotop padding
2	1	20059	Rubber iron support
3	1		Steam iron
4	1		Steam tube
5	1		Electric cable for iron
6	1		Cable support spring
7	1		Cable support
8	1		Coil
9	1		Connector
10	1		Steam feed joint 1/4"
11	1		Valve group
12	1		Safety valve plug
13	1		Rubber ring for wire
14	1		Cable support holder
15	2		Nut 1/4"
16	1		Plug OR gasket 3/4"
17	1		Nut 3/4"
18	2		Washers 3/4"
19	2		Washers 1/4"
20	1		Cover
21	1	20824	Mazzeri socket for iron
22	1		Mazzeri socket for arm
23	6		Clamps
24	2	21018	Board resistances
25	1		Connection joint 1/4" - 1/8"
26	2		T-Joints 1/8"
27	1		Safety valve
28	2		Curved joints 1/8"
29	1	21036	Manometer 1/8"
30	1	20420	Pressure switch 1/8"
31	1		Copper tube Ø6
32	1		Boiler
33	1	21914	Boiler cover
34	2	20591	Resistances
35	1		Exhaust joint
36	1		Exhaust tap
37	2	21095	Thermostats 170° C
38	1		Switchboard
39	1		Main switch
40	1		Main switch support
41	1		Pedal
42	1	21009	Pedal micro-switch
43	1		Electric cable
44	1		Frame
45	4		Rubber stoppers
46	3		Luminous switches 16 A
47	1		Jellow pilot lamp
48	3		Green pilot lamps
49	1	20179	Board thermostat 90° C
50	1		Rubber ring for wire
51	1		Linen support cloth
52	1	20209	Vacuum motor 230 V
53	1		Capacitor
54	1		Aluminium motor fan
55	1		Punched ironing board